

# Technical data sheet

## Cable ladder LG 50, 3 m FS

Item number: 6487012



Cable ladder with perforated side rail of side height 50 mm with riveted C profile rungs, open in an upwards direction. Assignment of the rungs on both sides possible using U clamps.

Magnetic shield insulation without cover 10 dB, with cover 15 dB.



CE

**St** Steel

**FS** Strip galvanized

### Master data

Item number	6487012
Type	LG 520 VS FS
Description 1	Cable ladder
Description 2	perforated
Manufacturer	OBO
Dimension	50x200x3000
Material	Steel
Surface	Strip galvanized
Surface standard	DIN EN 10346
Smallest sales unit	3
Unit of quantity	Metre
Weight	241.933 kg
Weight unit	kg/100 m

# Technical data sheet

## Cable ladder LG 50, 3 m FS

Item number: 6487012



### Dimensions

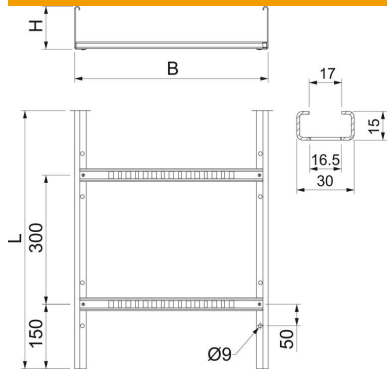

Length	3,000 mm
Length	3,000 ft
Width	200 mm
Height	50 mm

### Technical data

Usable cross-section	60 cm <sup>2</sup>
Usable cross-section	6000 mm <sup>2</sup>
Rung distance	300 mm
Rail thickness	1.5 mm

### Loads

Support spacing 2.0 m	0.7 kN/m
Support spacing 2.5 m	0.5 kN/m
Support spacing 3.0 m	0.35 kN/m

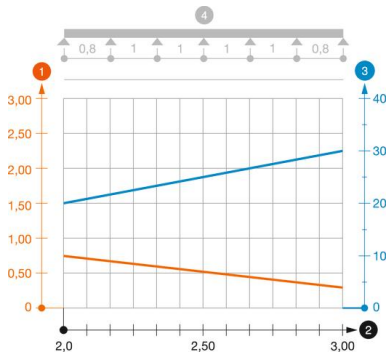

### Load diagram, cable ladder, type LG 5... VS

- 1 Permitted cable tray/ladder load in kN/m without man load
- 2 Support width in m
- 3 Rail bend in mm at permitted kN/m
- 4 Load scheme during testing
- Load curve with cable tray/ladder width in mm
- Strut bend curve according to support width